

REVISION			
LTR.	DESCRIPTION	DATE	APP

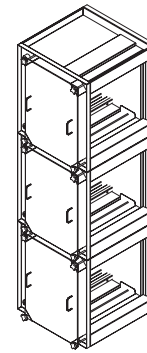
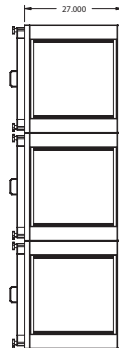
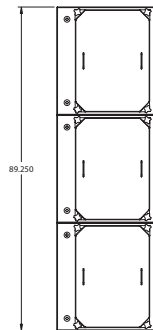
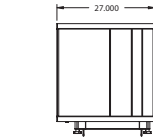

APPROXIMATE WEIGHT
WITHOUT FILTERS
600 LBS.

NOTE: BECAUSE WE ARE CONSTANTLY STRIVING TO IMPROVE OUR PRODUCTS,
WE RESERVE THE RIGHT TO PROVIDE VERSIONS OF THESE PRODUCTS WITH
SLIGHT VARIATIONS FROM THOSE ILLUSTRATED HERE.

©THIS DRAWING AND DESIGN IS THE
EXCLUSIVE PROPERTY OF STROBIC AIR®
CORP. AND IS COPYRIGHTED. IT MUST
NOT BE COPIED, OR USED FOR
PRODUCTION, OR COMMUNICATED TO A
THIRD PARTY, WITHOUT THE EXPRESSED
WRITTEN PERMISSION OF THIS COMPANY.

UNLESS OTHERWISE SPECIFIED DIMENSIONS ARE IN INCHES TOLERANCES ARE - .001 -	CONTRACT NO.		3X1 HEPA FILTER UNIT: MAX 6,000 CFM		
	APPROVALS	DATE	STROBIC AIR® CORPORATION A SUBSIDIARY OF MET-PRO CORP. HARLEYSVILLE, PA		
	DRAWN	E.C.A.			2/15/05
MATERIAL	CHECKED	LAYOUT	SIZE	CODE IDENT. NO.	
FINISH	U.S. PATENT NO. 6,431,974 U.S. PATENT NO. 6,112,850 U.S. PATENT NO. 4,806,706 CANADIAN PATENT NO. 1,277,171		B	3X1	DRAWING NO. 021505E-4
SCALE: N.T.S.			SHEET ___ OF ___		1 1