

# **Strobic Air<sup>®</sup> Technology**

**Expands our fume  
exhaust offering  
to include the  
Mono-Stack**

## **Features & Benefits**

- ✓ Wheel sizes ranging from 12" to 36"
- ✓ Airflow capacities to 24,000 cfm
- ✓ ESP to 8" w.g.
- ✓ Direct drive, low maintenance (no belts or couplings)
- ✓ Premium efficient VFD duty motors
- ✓ AMCA C or B spark resistant construction
- ✓ Efficient nozzle design with high velocity plume dispersion
- ✓ Modular plenum design
- ✓ Heat recovery option available



*The Power of Innovation™*

**STROBIC AIR  
TECHNOLOGIES**

A CECO Environmental Company



**CECO**  
ENVIRONMENTAL

## Mono-Stack Exploded Assembly Drawing

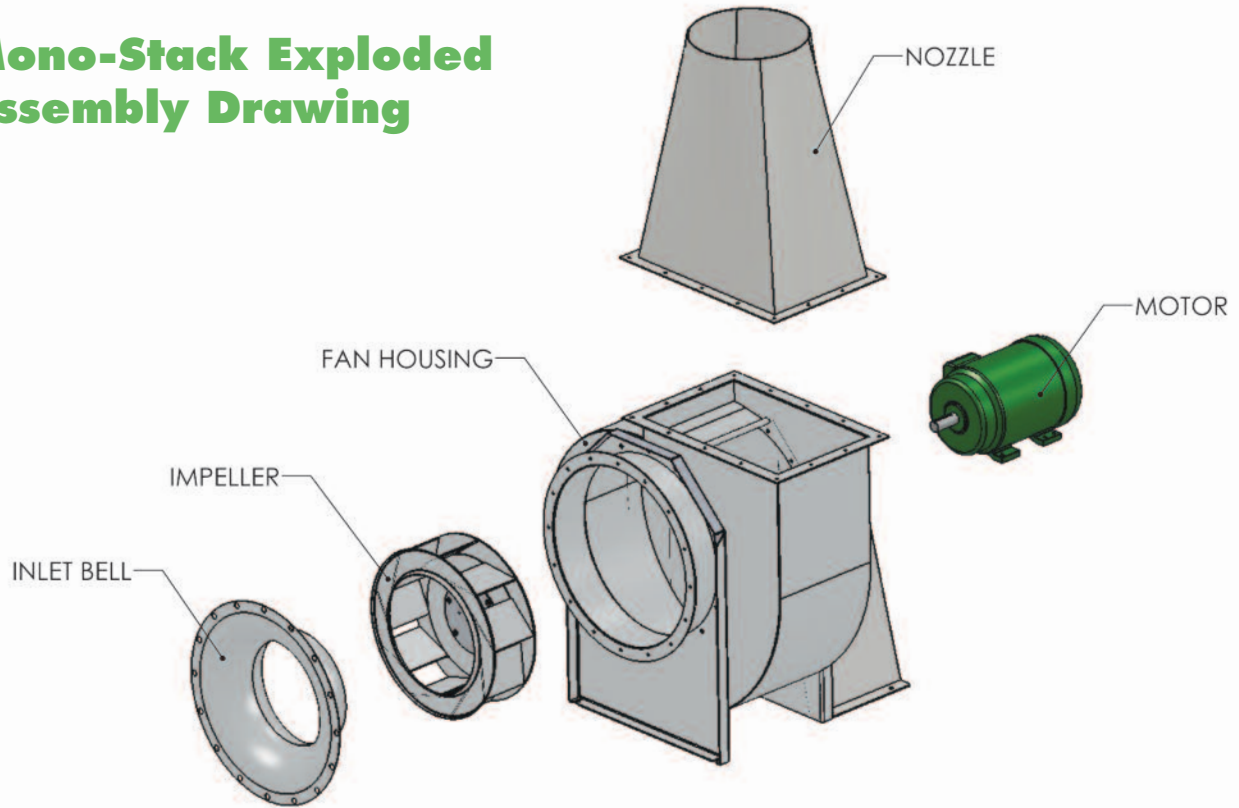

## Modular Plenum Design

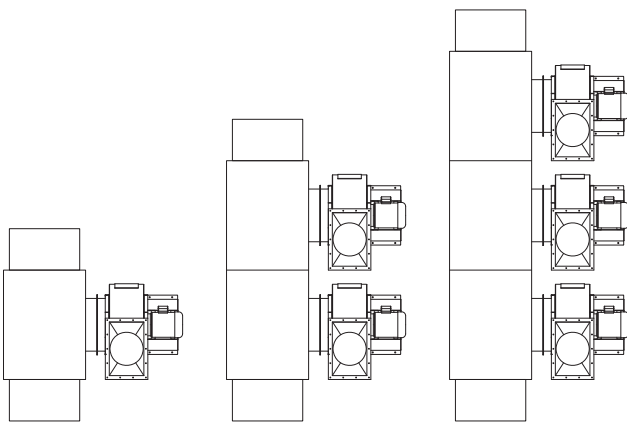

## Heat Recovery Unit

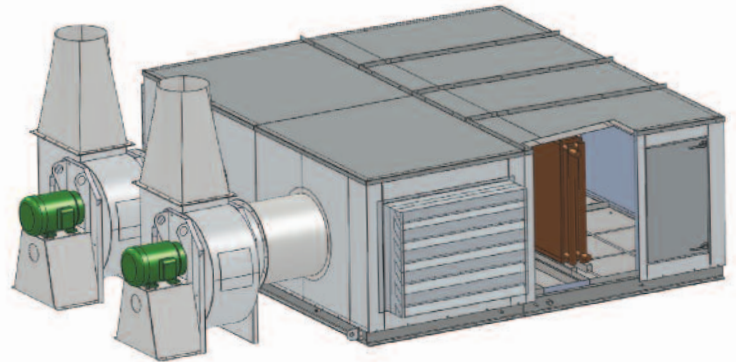

The Power of Innovation™

**STROBIC AIR**  
TECHNOLOGIES

A CECO Environmental Company

700 Emlen Way, Telford, PA 18969  
215-723-4700, 800-SAG-FANS, Fax: 215-723-7401  
tristack@strobicair.com, www.choosetrystack.com

02-5041 1215

**CECO**  
ENVIRONMENTAL